

# FOR LEASE

Office/Warehouse - Sanford Central Park  
3965 St Johns Parkway

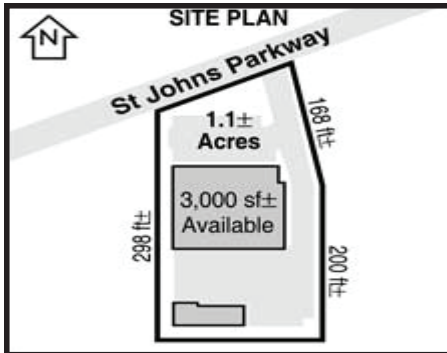

- 3,000sf END CAP location
- 40% office/60% warehouse
- Landlord pays CAM, Cat-5 wiring, 3-phase power
- Energy-Efficient Construction
- Open warehouse with grade overhead door
- Common loading dock on site
- Pull-up parking both front and rear
- Locally owned and managed

**Penney Lawrence (407) 353-7019**  
**info@DaveBrewerProperties.com**  
**www.SeeOurNewOffice.com**

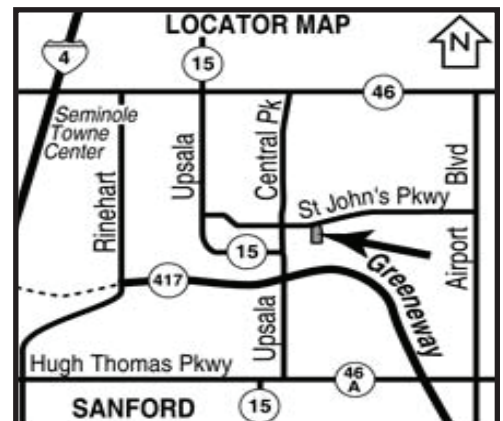

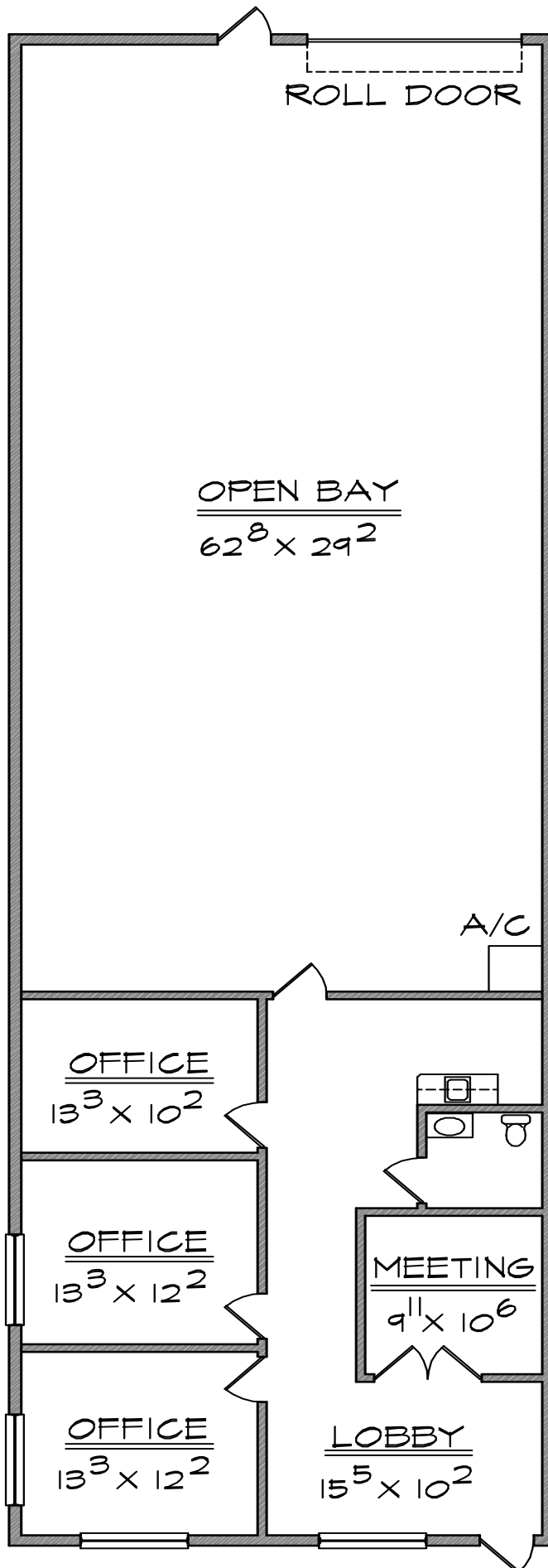

3965 ST. JOHNS PARKWAY